

# FIXED LEVER WITH MALE THREADED STUD

# A529



**Material:**

Reinforced Polyamide.  
Oils and grases resistant.

**Surface:**

Satin.

**Colour:**

Black (RAL 9011).

**Main insert:**

Zinc plated steel threaded stud.  
(Thread tolerance 6g).

**SPECIAL REQUESTS:**

- It's possible to supply the inserts with different lengths, on request and for quantities.
- It's possible to supply the inserts with different materials, on request and for quantities.
- It's possible to supply the lever body with colours as shown in the table at page A-31 on request and for quantities.

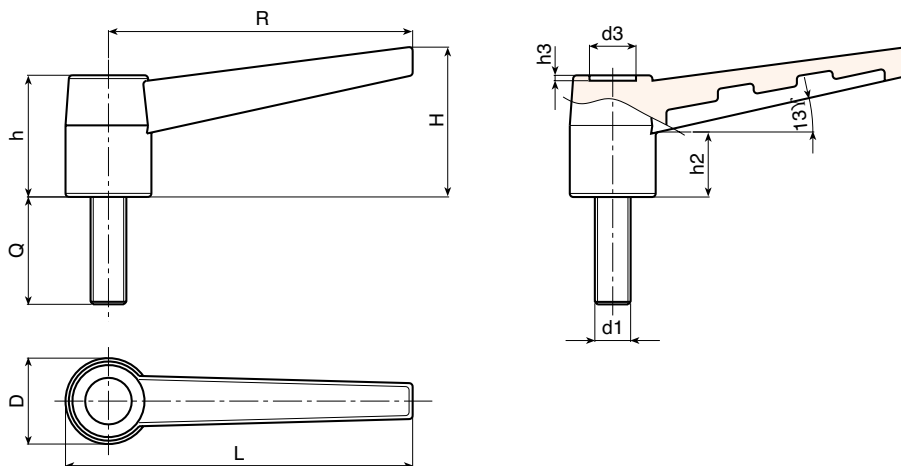

Art.	L	R	H	D	h	h2	h3	d3	LM	d1 6g	Q	g
<b>A52943.TM05X..01</b>	50	<b>43</b>	21,5	15	19	9	1	7	30	<b>M05</b>	10-20-30	9-10-11
<b>A52943.TM06X..01</b>	50	<b>43</b>	21,5	15	19	9	1	7	30	<b>M06</b>	10-20-30-40	10-12-14-16
<b>A52968.TM06X..01</b>	78	<b>68</b>	36	21	28,5	11	2	10	50	<b>M06</b>	10-20-30-40	25-27-29-31
<b>A52968.TM08X..01</b>	78	<b>68</b>	36	21	28,5	11	2	10	50	<b>M08</b>	16-20-30-40	30-32-36-39
<b>A52983.TM06X..01</b>	93	<b>83</b>	40	24	34	18	2	13	60	<b>M06</b>	20-30	41-43
<b>A52983.TM08X..01</b>	93	<b>83</b>	40	24	34	18	2	13	60	<b>M08</b>	20-30-40-50-60	44-47-50-53-56
<b>A52983.TM10X..01</b>	93	<b>83</b>	40	24	34	18	2	13	60	<b>M10</b>	20-30-40	48-53-58

Enter the stud length choice in the two .. of the article code. Lengths by request with 100 pieces minimum quantity.

**LM = Maximum mouldable length.**

Presumable presence in the stock in %

(☺) 90% (☹) 40% (⊖) 5% (⊕)

BOTECO® - © All right reserved - [www.boteco.it](http://www.boteco.it)

Any unauthorized reproduction is strictly forbidden



**BOTECO**