

F178



PA6
+GF

UL94
HB



SOLID 6 LOBE HANDWHEEL WITH MALE THREADED STUD

Material:

Reinforced polyamide.
Oils and greases resistant.

Surface:

Satin.

Colour:

Black (RAL 9011).

Main Insert:

Zinc plated steel threaded stud (tolerance 6g).

SPECIAL REQUESTS:

- It is possible to supply inserts in different lengths or by special design, on request and for quantities.
- It is possible to supply inserts in different materials, on request and for quantities.
- It is possible to supply colours as shown in the table on page F-35, on request and for quantities.

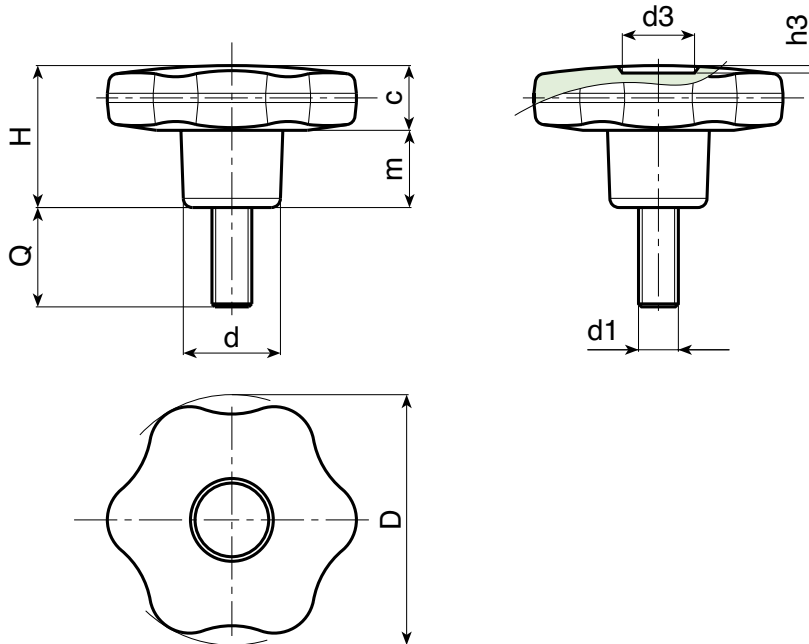

Art.	D	H	d	c	m	d3	h3	LM	d1	eg	Q	g
F17830.TM05X..01	30	22	15	11	11	9	1,5	80	M05		16-20-30	14-15-16
F17830.TM06X..01	30	22	15	11	11	9	1,5	80	M06		16-20-30	16-17-18
F17830.TM08X..01	30	22	15	11	11	9	1,5	80	M08		16-20-30-40	19-21-25-28
F17830.TM10X..01	30	22	15	11	11	9	1,5	80	M10		20-30-40	28-33-39
F17840.TM06X..01	40	24,5	17	12	12,5	12	1	130	M06		16-20-30-40	25-25-27-28
F17840.TM08X..01	40	24,5	17	12	12,5	12	1	130	M08		20-30-40-50	30-33-36-39
F17840.TM10X..01	40	24,5	17	12	12,5	12	1	130	M10		20-30-40-50	37-41-45-49
F17850.TM08X..01	50	29	20	14	15	14,5	1,5	130	M08		20-30-40	49-52-55
F17850.TM10X..01	50	29	20	14	15	14,5	1,5	130	M10		20-30-40-50	55-60-61-64
F17850.TM12X..01	50	29	20	14	15	14,5	1,5	130	M12		20-30-40-50	63-67-72-77
F17860.TM08X..01	60	34	24	16	18	18	1,5	130	M08		20-30-40	68-71-74
F17860.TM10X..01	60	34	24	16	18	18	1,5	130	M10		20-30-40-50	74-80-85-88
F17860.TM12X..01	60	34	24	16	18	18	1,5	130	M12		20-30-40-50	95-102-109-116
F17860.TM14X..01	60	34	24	16	18	18	1,5	130	M14		30-40-50	103-113-122

Enter the stud length choice in the two .. of the article code. Lengths by request with 250 pieces minimum quantity.

LM = Maximum mouldable length.

F - SOLID
LOCKING KNOBS

ver. FUK.15-0413



BOTECA

F - 10

Presumable presence in the stock in %

(☹) 90% (😊) 40% (😐) 5% (☹)

www.boteco.it - © All right reserved - BOTECA®

Any unauthorized reproduction is strictly forbidden