

# SOLID CROSS HANDWHEEL WITH THREADED STUD

## F189



### Material:

Reinforced polyamide.  
Oils and greases resistant.

### Surface:

Satin.

### Colour:

Black (RAL 9011).

### Main Insert:

Zinc plated steel threaded stud (tolerance 6g).

### SPECIAL REQUESTS:

- It is possible to supply inserts in different lengths or by special design, on request and for quantities.
- It is possible to supply inserts in different materials, on request and for quantities.
- It is possible to supply colours as shown in the table on page F-35, on request and for quantities.

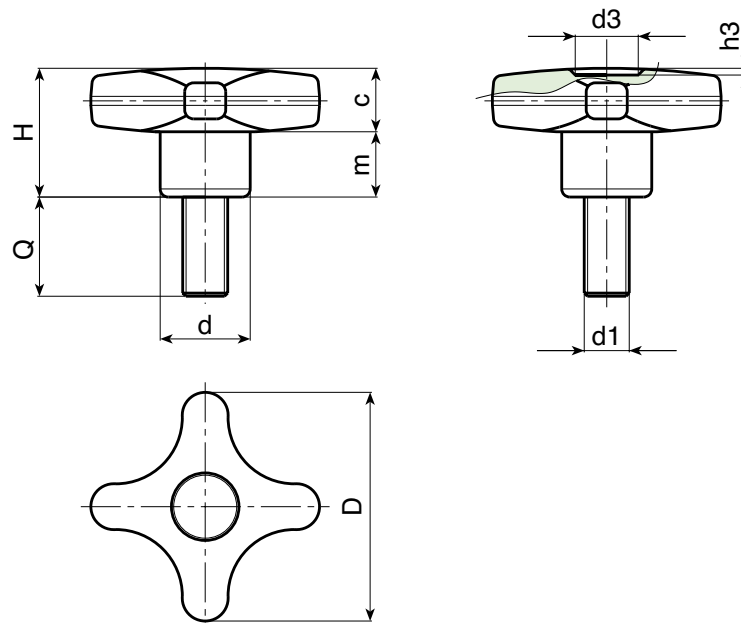

Art.	D	H	d	c	m	d3	h3	LM	d1	eg	Q	g
F18932.TM05X..01	32	23	15	11	11	9	1,5	80	M05	16-20-30	14-15-16	
F18932.TM06X..01	32	23	15	11	11	9	1,5	80	M06	16-20-30	15-16-17	
F18932.TM08X..01	32	23	15	11	11	9	1,5	80	M08	16-20-30-40	19-21-23-25	
F18932.TM10X..01	32	23	15	11	11	9	1,5	80	M10	20-30-40	24-27-30	
F18940.TM06X..01	40	24,5	17	12	12,5	12	1	80	M06	20-30-40-50	20-21-22-25	
F18940.TM08X..01	40	24,5	17	12	12,5	12	1	80	M08	20-30-40-50	24-29-33-37	
F18940.TM10X..01	40	24,5	17	12	12,5	12	1	80	M10	20-30-40-50	30-35-41-47	
F18950.TM08X..01	50	29	20	14	15	14,5	1,5	80	M08	20-30-40	38-42-46	
F18950.TM10X..01	50	29	20	14	15	14,5	1,5	80	M10	20-30-40-50	49-55-61-65	
F18950.TM12X..01	50	29	20	14	15	14,5	1,5	80	M12	20-30-40-50	51-57-63-70	
F18960.TM08X..01	60	34	24	15,5	18,5	18	1,5	80	M08	20-30-40	47-50-53	
F18960.TM10X..01	60	34	24	15,5	18,5	18	1,5	80	M10	20-30-40-50	64-68-72	
F18960.TM12X..01	60	34	24	15,5	18,5	18	1,5	80	M12	20-30-40-50	78-85-91-99	
F18960.TM14X..01	60	34	24	15,5	18,5	18	1,5	80	M14	30-40-50	82-91-103	

Enter the stud length choice in the two .. of the article code. Lengths by request with 250 pieces LM minimum quantity.

LM = Maximum mouldable length.

Presumable presence in the stock in %

(☺) 90% (☹) 40% (⊖) 5% (⊕)

BOTECO® - © All right reserved - www.boteco.it

Any unauthorized reproduction is strictly forbidden



BOTECO

F - 21

F - SOLID  
LOCKING KNOBS

ver. FUK.15-0413