

G650



6-LOBE HANDWHEEL WITH CAP AND THREADED FEMALE INSERT

Material:

Reinforced polyamide.
Oils and greases resistant.

Surface:

Satin.

Colour:

Black (RAL 9011).

Central Cap:

Grey polyamide (RAL 7035 cod. 13).

Alternative Cap Colour:

Orange (RAL 2004 cod. 02)
Blue (RAL 5015 cod. 07)
Yellow (RAL 1021 cod. 10)
Red (RAL 3000 cod. 16)
Green (RAL 6024 cod. 17)
Black (RAL 9011 cod. 01)

Main Insert:

Brass blind threaded bush (tolerance 6H).



SPECIAL REQUEST:

- It is possible to supply the inserts in different materials, on request and for quantities.
- It is possible to supply colours as shown in the table at pag. G-23, on request and for quantities.

PAD PRINTING SERVICE:

- Upon request and for special quantities caps can be supplied with customized pad printing.

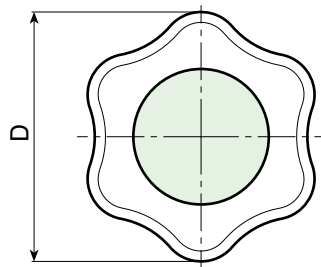
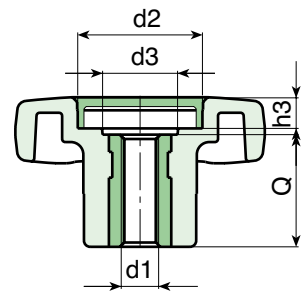
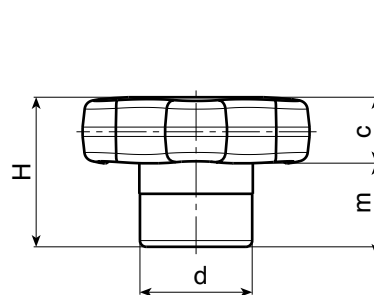
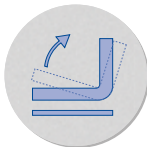

	art.	D	H	d	m	c	d2	d3	h3	d1 6g	Q	Δ g
	G65040.TM0601	40	24	18	10,5	13,5	20	13	6	M06	18	18
	G65040.TM0801	40	24	18	10,5	13,5	20	13	6	M08	18	19
	G65040.TM1001	40	24	18	10,5	13,5	20	13	6	M10	18	20

**G - LOCKING
HANDWHEELS**

ver. GUK.11-1113



G - 4

Availability of stock in %

(☹) 90% (😊) 40% (☺) 5% (☹)

www.boteco.it - © All right reserved - BOTECA®
Any unauthorized reproduction is strictly forbidden