

# G730



PA6  
+GF

UL94  
HB



## 4-LOBE HANDWHEEL WITH THREADED FEMALE INSERT

### Material:

Reinforced polyamide. Oils and greases resistant.

Surface: Satin.

Colour: Black (RAL 9011).

### Main Insert:

Brass blind threaded bush (tolerance 6H).

(\*) Zinc plated steel blind threaded bush (tolerance 6H).

### SPECIAL REQUEST:

- It is possible to supply the inserts in different materials, on request and for quantities.
- It is possible to supply colours as shown in the table at pag. G-23, on request and for quantities.

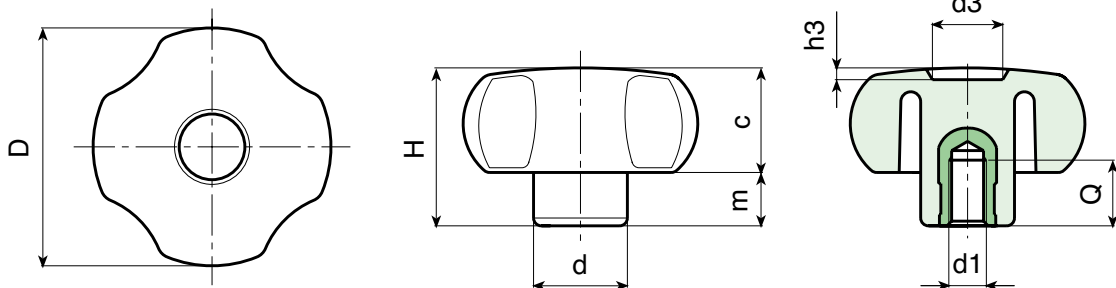

	art.	D	H	d	c	m	d3	h3	d1 6H	Q	g
☹️	G73020.TM0401	21	14	11	8,5	5,5	8	1,5	M04	13	5
😊	G73020.TM0501	21	14	11	8,5	5,5	8	1,5	M05	13	5
😊	G73020.TM0601	21	14	11	8,5	5,5	8	1,5	M06	13	5
😊	G73025.TM0401	26	16	12	10	6	10	1,5	M08	7	6
😊	G73025.TM0501	26	16	12	10	6	10	1,5	M05	7	6
😊	G73025.TM0601	26	16	12	10	6	10	1,5	M06	7	7
😊	G73025.TM0801	26	16	12	10	6	10	1,5	M08	7	8
😊	G73030.TM0501	30	23	15	13,5	9,5	12	2	M05	13	12
😊	G73030.TM0601	30	23	15	13,5	9,5	12	2	M06	10	12
😊	G73030.TM0801	30	23	15	13,5	9,5	12	2	M08	16	14
☹️	G73030.TM1001	30	23	15	13,5	9,5	12	2	M10	16	14
☹️	G73040.TM0501	40,5	29,5	15,5	18,5	11	12	3	M05	13	21
😊	G73040.TM0601	40,5	29,5	15,5	18,5	11	12	3	M06	10	21
😊	G73040.TM0801	40,5	29,5	15	18,5	11	12	3	M08	14	22
😊	G73040.TM1001	40,5	29,5	17,5	18,5	11	12	3	M10	13	26
😊	G73040.TM1201	40,5	29,5	21	18,5	11	12	3	M12	11	30
☹️	G73050.TM0601	49	32	20,5	21,5	11	14,5	2,5	M06	10	35
😊	G73050.TM0801	49	32	20,5	21,5	11	14,5	2,5	M08	14	42
😊	G73050.TM1001	49	32	20,5	21,5	11	14,5	2,5	M10	13	43
😊	G73050.TM1201	49	32	20,5	21,5	11	14,5	2,5	M12	17	48
😊	G73060.TM0801	59	40	23	25	15	24	4	M08	15	60
😊	G73060.TM1001	59	40	23	25	15	24	4	M10	14	62
😊	G73060.TM1201	59	40	23	25	15	24	4	M12	18	67
😊	G73060.TM1401	59	40	23	25	15	24	4	M14	19	70
😊	G73060.TM1601	59	40	23	25	15	24	4	(*) M16	17	82
😊	G73080.TM1001	79	41	30	24	17	21	3	M10	14	88
😊	G73080.TM1201	79	41	30	24	17	21	3	M12	16	88
😊	G73080.TM1401	79	41	30	24	17	21	3	M14	19	97
😊	G73080.TM1601	79	41	30	24	17	21	3	(*) M16	17	109
☹️	G73080.TM2001	79	41	30	24	17	21	3	(*) M20	16	115

G - LOCKING  
HANDWHEELS

ver. GUK.11-1113



BOTECA

G - 6

Presumable presence in the stock in %

(☹️) 90% (😊) 40% (☹️) 5% (☹️)

www.boteco.it - © All right reserved - BOTECA

Any unauthorized reproduction is strictly forbidden