

# KNURLED HANDWHEEL WITH SCREWDRIVERS SLOT AND THREADED STUD

## H172



PA6  
+GF

UL94  
HB



### Material:

Reinforced polyamide.  
Oils and greases resistant.

### Surface:

Satin.

### Colour:

Black (RAL 9011).

### Main Insert:

Zinc plated steel threaded stud (tolerance 6g).

### SPECIAL REQUESTS:

- It is possible to supply inserts in different lengths or by special design, on request and for quantities.
- It is possible to supply inserts in different materials, on request and for quantities.
- It is possible to supply colours as shown in the table on page H-19, on request and for quantities.

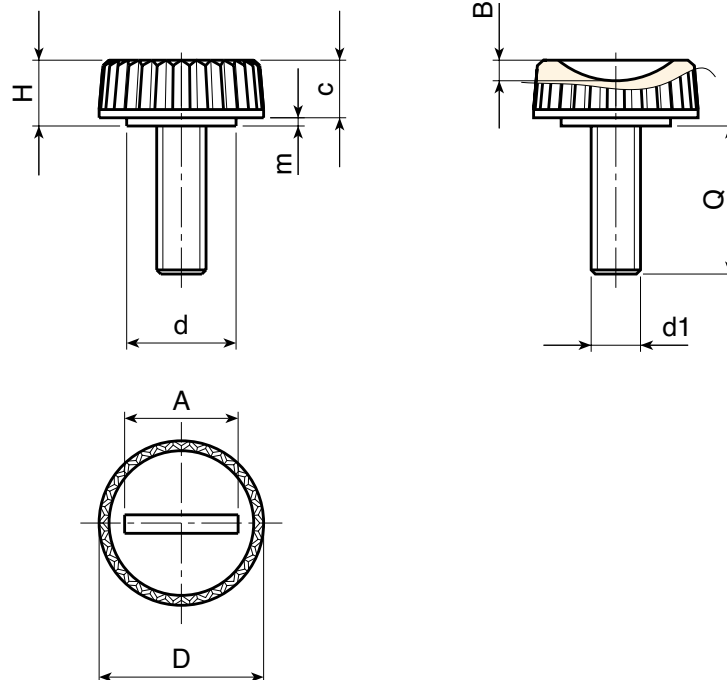

	art.	D	H	d	m	c	A	B	LM	d1 6g	Q	g
	H17220.TM06X..01	20	8	13,5	1	7	14	2,5	39	M06	A.R.	

Enter the stud length choice in the two .. of the article code. Lengths by request with 500 pieces minimum quantity.

LM = Maximum mouldable length.

A.R. = by request.

Presumable presence in the stock in %

(☺) 90% (☹) 40% (☹) 5% (☹)

BOTECO® - © All right reserved - [www.boteco.it](http://www.boteco.it)  
Any unauthorized reproduction is strictly forbidden



BOTECO

H - 17

**H - KNURLED  
HANDWHEELS**

ver. HUK.10-0113