

H753



PA6
+GF

UL94
HB



KNURLED SOLID HANDWHEEL WITH THREADED STUD

Material:

Reinforced polyamide.
Oils and greases resistant.

Surface:

Satin.

Colour:

Black (RAL 9011).

Main Insert:

Zinc plated steel threaded stud (tolerance 6g).

SPECIAL REQUESTS:

- It is possible to supply inserts in different lengths or by special design, on request and for quantities.
- It is possible to supply inserts in different materials, on request and for quantities.
- It is possible to supply colours as shown in the table on page H-19, on request and for quantities.

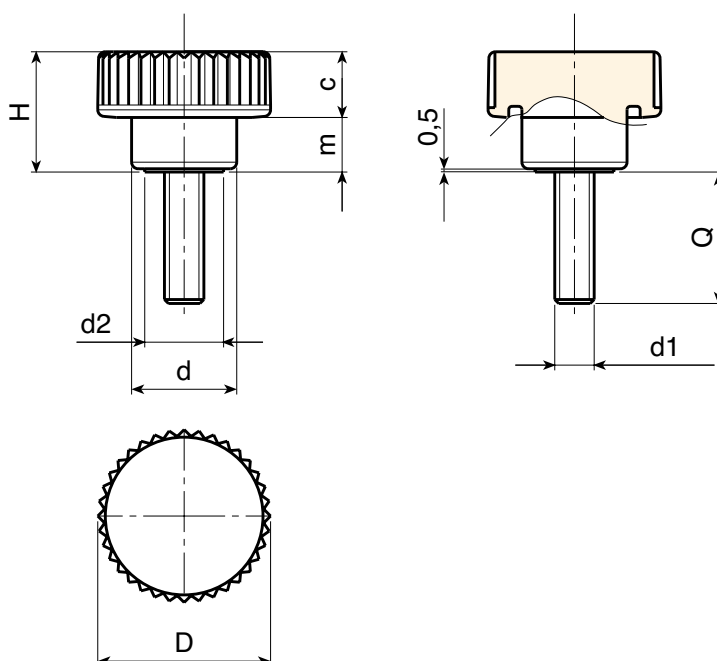

	art.	D	H	d	m	c	d2	LM	d1 6g	Q	g
	H75326.TM05X2501	26	18	16	8,5	9,5	12	50	M05	25	10
	H75326.TM06X3001	26	18	16	8,5	9,5	12	50	M06	30	11,5
	H75326.TM08X4001	26	18	16	8,5	9,5	12	50	M08	40	15

LM = Maximum mouldable length.

It's possible to have different length, by customers requests. Minimum 250 pieces.

**H - KNURLED
HANDWHEELS**

ver. HUK.10-0113



BOTECA

H - 8

Presumable presence in the stock in %

(☺) 90% (☹) 40% (☹) 5%

www.boteco.it - © All right reserved - BOTECA®
Any unauthorized reproduction is strictly forbidden