

H774



PA6
+GF

UL94
HB



KNURLED HANDWHEEL WITH SCREWDRIVERS SLOT AND THREADED STUD

Material:

Reinforced polyamide.

Oils and greases resistant.

Surface:

Satin.

Colour:

Black (RAL 9011).

Main Insert:

Zinc plated steel threaded stud (tolerance 6g).

SPECIAL REQUESTS:

- It is possible to supply inserts in different lengths or by special design, on request and for quantities.
- It is possible to supply inserts in different materials, on request and for quantities.
- It is possible to supply colours as shown in the table on page H-19, on request and for quantities.

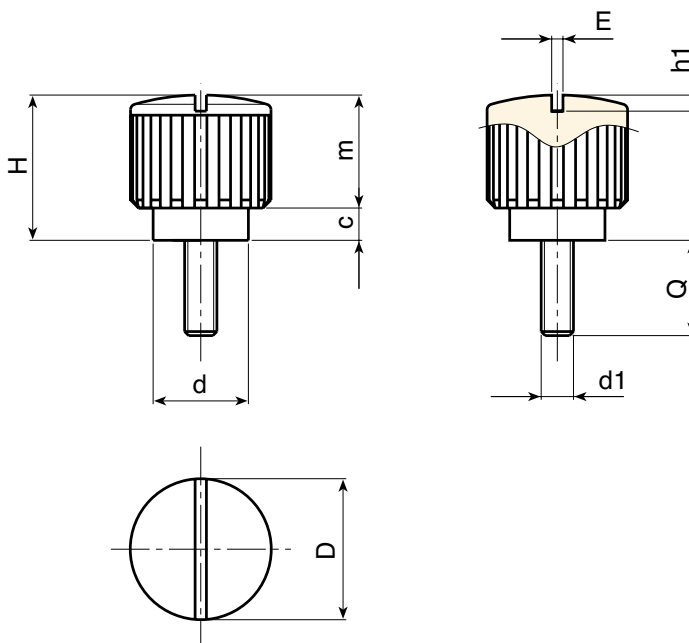

	art.	D	H	d	m	c	A	B	LM	d1 6g	Q	g
	H77418.TM04X..01	17,5	18	12	4	14	1,2	1,5	50	M04	A.R.	
	H77418.TM05X..01	17,5	18	12	4	14	1,2	1,5	60	M05	A.R.	
	H77418.TM06X..01	17,5	18	12	4	14	1,2	1,5	60	M06	A.R.	

Enter the stud length choice in the two .. of the article code. Lengths by request with 250 pieces minimum quantity.

LM = Maximum mouldable length.

A.R. = by request.

**H - KNURLED
HANDWHEELS**

ver. HUK.10-0113



BOTECA

H - 16

Presumable presence in the stock in %

(☹) 90% (☺) 40% (☹) 5% (☹)

www.boteco.it - © All right reserved - BOTECA®
Any unauthorized reproduction is strictly forbidden