

# CONICAL KNOB WITH CAP AND THREADED STUD

# 1126



## Material:

Reinforced polyamide.  
Oils and greases resistant.

## Surface:

Satin.

## Colour:

Black (RAL 9011).

## Central Cap:

Grey polyamide (RAL 7035 cod. 13).

## Alternative Cap Colour:

Orange (RAL 2004 cod. 02)  
Blue (RAL 5015 cod. 07)  
Yellow (RAL 1021 cod. 10)  
Red (RAL 3000 cod. 16)  
Green (RAL 6024 cod. 17)  
Black (RAL 9011 cod. 01)

## Main Insert:

Zinc plated steel threaded stud (tolerance 6g).

## SPECIAL REQUESTS:

- It is possible to supply inserts in different lengths or by special design, on request and for quantities.
- It is possible to supply inserts in different materials, on request and for quantities.
- It is possible to supply colours as shown in the table on page I-23, on request and for quantities.

## PAD PRINTING SERVICE:

- Upon request and for special quantities caps can be supplied with customized pad printing.

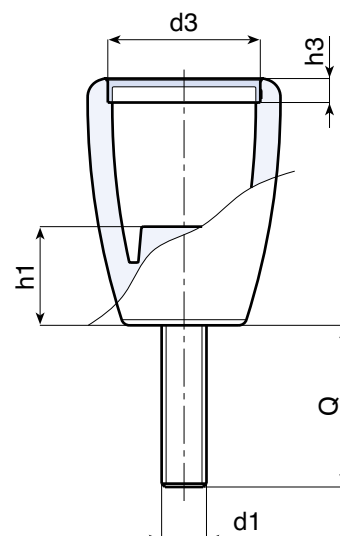
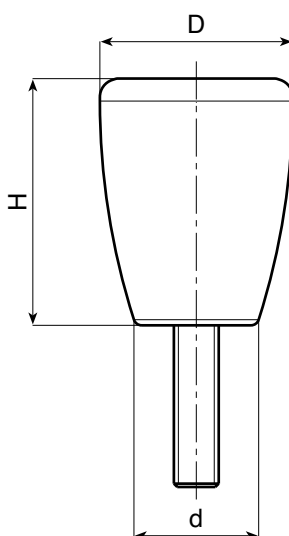

	art.	D	H	d	h1	d3	h3	LM	d1 $\epsilon_g$	Q	$\Delta$ g
☹	I12643.TM08X..01	43	55	27	30	34	5,5	80	M08	A.R.	-
☹	I12643.TM10X..01	43	55	27	30	34	5,5	80	M10	A.R.	-
☹	I12643.TM12X..01	43	55	27	30	34	5,5	80	M12	A.R.	-

Enter the stud length choice in the two .. of the article code. Lengths by request with 500 pieces minimum quantity.

LM = Maximum mouldable length.

A.R. = by request.

Availability of stock in %

(☹) 90%(☺) 40%(☹) 5%(☹)

BOTECO® - © All right reserved - [www.boteco.it](http://www.boteco.it)  
Any unauthorized reproduction is strictly forbidden



I  
HANDGRIPS