

# P901

P908 - P909 - P910  
P901CIN - P908CIN

# MOUNTING FOOT WITH STEEL AND STAINLESS STEEL STUD AND NON-SLIP TPV BASE

## P901 Version - Mounting foot with stud type A - R12,5 and non-slip TPV base

	Art.	D	D2	H	H1	H3	E	s	R	d1	Q	⚖ g	F1 (N)
😊	P90140.TM08X..01	40	34	17	23	26	⊘ 13	5	12,5	M08	45-70	44-51	10.000
😊	P90140.TM10X..01	40	34	17	23	26	⊘ 13	5	12,5	M10	45-70-100	52-64-79	10.000
😊	P90140.TM12X..01	40	34	17	23	26	⊘ 13	5	12,5	M12	45-70-100	62-79-101	10.000
😊	P90150.TM08X..01	50	43	18	24	27	⊘ 13	5	12,5	M08	45-70	66-74	10.000
😊	P90150.TM10X..01	50	43	18	24	27	⊘ 13	5	12,5	M10	45-70-100	76-88-103	10.000
😊	P90150.TM12X..01	50	43	18	24	27	⊘ 13	5	12,5	M12	45-70-100	86-104-125	10.000
😊	P90160.TM08X..01	60	53	20	26	29	⊘ 13	5	12,5	M08	45-70	52-59	10.000
😊	P90160.TM10X..01	60	53	20	26	29	⊘ 13	5	12,5	M10	45-70-100	60-69-83	10.000
😊	P90160.TM12X..01	60	53	20	26	29	⊘ 13	5	12,5	M12	45-70-100	70-84-105	10.000

Enter the stud length in the two . . of the code number.

## P908 Version - Mounting foot with stud type A - R15 and non-slip TPV base

	Art.	D	D2	H	H1	H3	E	s	R	d1	Q	⚖ g	F1 (N)
	P90860.TM12X..01	60	53	20	26	29	⊘ 16	6,5	15	M12	50-70-90-110	pag.30	13.000
	P90860.TM14X..01	60	53	20	26	29	⊘ 16	6,5	15	M14	50-70-90-110-130-150	pag.29	13.000
	P90860.TM16X..01	60	53	20	26	29	⊘ 16	6,5	15	M16	50-70-90-110-130-150-170-190	pag.29	13.000

Enter the stud length in the two . . of the code number. It's possible to have different lengths, by customers requests. Minimum 100 pieces.

## P909 Version - Mounting foot with stud type B - R12,5 and non-slip TPV base

	Art.	D	D2	H	H1	H3	E	s	R	d1	Q	⚖ g	F1 (N)
	P90960.TM16X..01	60	53	20	26	29	⊘ 13	7	12,5	M16	50-70-90-110-130-150-170	pag.30	13.000

Enter the stud length in the two . . of the code number. It's possible to have different lengths, by customers requests. Minimum 100 pieces.

## P910 Version - Mounting foot with stud type B - R15 and non-slip TPV base

	Art.	D	D2	H	H1	H3	E	s	R	d1	Q	⚖ g	F1 (N)
☹	P91060.TM20X..01	60	53	20	26	29	⊘ 16	7	15	M20	50-70-90-110-130-150-170-190-210	pag.30	13.000

Enter the stud length in the two . . of the code number. It's possible to have different lengths, by customers requests. Minimum 100 pieces.

## P901 CIN Version - Mounting foot with stud type A - R12,5 in stainless steel - with non-slip TPV base

**INOX**

	Art.	D	D2	H	H1	H3	E	s	R	d1	Q	⚖ g	F1 (N)
☹	P90140.TM08X..01CIN	40	34	17	23	26	⊘ 13	5	12,5	M08	45-70	40-47	10.000
☹	P90140.TM10X..01CIN	40	34	17	23	26	⊘ 13	5	12,5	M10	45-70	48-60	10.000
☹	P90140.TM12X..01CIN	40	34	17	23	26	⊘ 13	5	12,5	M12	45-70-100	58-75-97	10.000
☹	P90150.TM08X..01CIN	50	43	18	24	27	⊘ 13	5	12,5	M08	45-70	46-53	10.000
☹	P90150.TM10X..01CIN	50	43	18	24	27	⊘ 13	5	12,5	M10	45-70	54-63	10.000
☹	P90150.TM12X..01CIN	50	43	18	24	27	⊘ 13	5	12,5	M12	45-70-100	64-78-99	10.000
☹	P90160.TM08X..01CIN	60	53	20	26	29	⊘ 13	5	12,5	M08	45-70	58-66	10.000
☹	P90160.TM10X..01CIN	60	53	20	26	29	⊘ 13	5	12,5	M10	45-70	68-80	10.000
☹	P90160.TM12X..01CIN	60	53	20	26	29	⊘ 13	5	12,5	M12	45-70-100	78-96-117	10.000

Enter the stud length in the two . . of the code number. It's possible to have different lengths, by customers requests. Minimum 100 pieces.

## P908 CIN Version - Mounting foot with stud type A - R15 in stainless steel - with non-slip TPV base

**INOX**

	Art.	D	D2	H	H1	H3	E	s	R	d1	Q	⚖ g	F1 (N)
☹	P90860.TM12X..01CIN	60	53	20	26	29	⊘ 17	6,5	15	M12	50-70-90	pag.30	13.000
☹	P90860.TM14X..01CIN	60	53	20	26	29	⊘ 17	6,5	15	M14	50-70-90-110-130	pag.30	13.000
☹	P90860.TM16X..01CIN	60	53	20	26	29	⊘ 17	6,5	15	M16	50-70-90-110-130-150-170	pag.30	13.000

Enter the stud length in the two . . of the code number. It's possible to have different lengths, by customers requests. Minimum 100 pieces.

# P901



**Material:**

Reinforced polyamide.  
Oils and greases resistant.

**Surface:**

Satin.

**Colour:**

Black (RAL 9011).

**Inserts:**

**Version P901 - P908 - P909 - P910:** Zinc plated steel articulated, threaded stud.

**Version P901 CIN - P908 CIN:** Threaded and articulated stainless steel stud (AISI 303).

**Non-Slip Base:**

Thermoplastic vulcanized rubber TPV 75 Shore (only black RAL 9011).

**SPECIAL REQUESTS:**

- It is possible to supply the inserts with different lengths, on request and for quantities.
- Upon request and for special quantities the foot can be supplied in Orange (RAL 2004).



Art. P900 CIN

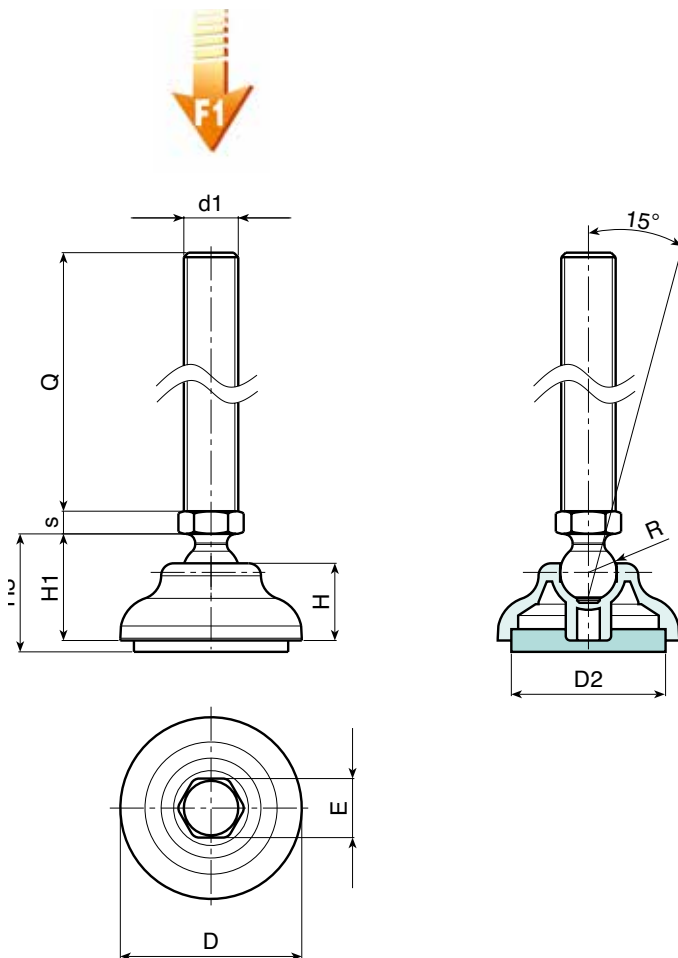

Stud type A

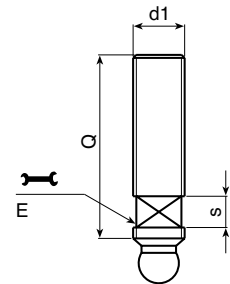

Stud type B

Presumable presence in the stock in %

(☺) 90% (☹) 40% (⊖) 5% (⊕)

BOTECO® - © All right reserved - [www.boteco.it](http://www.boteco.it)  
Any unauthorized reproduction is strictly forbidden



BOTECO