

Y099 PIN



DIN 99 - L DESIGN - N DESIGN STAINLESS STEEL FIXED LEVER WITH TAPER ARM

Material:
Turned stainless steel body, (Aisi 303).

Surface finish:
Sandblasted satin finish.
Colour:
Standard natural.

Hole:
INM: Threaded through hole
(thread tolerance 6H).
IND: Smooth through hole, (thread tolerance 7H).

SPECIAL REQUESTS:

- None.

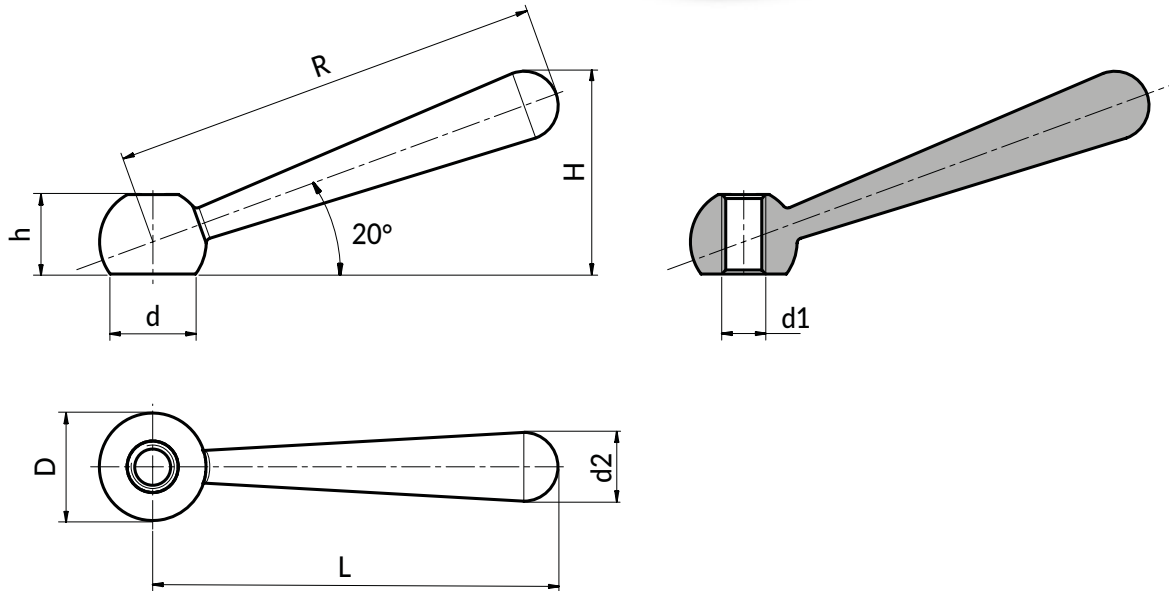

Version Y099 PIN INM: N Design with threaded hole

INOX

	Art.	R	L	D	d	d2	h	H	d1 6H	g
●	Y099063.INM08PIN	63	60	16	12,5	10	12	30	M08	36
●	Y099080.INM10PIN	80	76	20	16	13	14,5	38	M10	74
●	Y099100.INM12PIN	100	95	25	20	16	18,5	47	M12	141
●	Y099125.INM16PIN	125	119	32	25	20	24	59,5	M16	278
●	Y099160.INM20PIN	160	152	40	31	25	30	75,5	M20	564

Version Y099 PIN IND: L Design with smooth hole

INOX

	Art.	R	L	D	d	d2	h	H	d1 H7	g
●	Y099063.IND08PIN	63	60	16	12,5	10	12	30	08	36
●	Y099080.IND10PIN	80	76	20	16	13	14,5	38	10	74
●	Y099100.IND12PIN	100	95	25	20	16	18,5	47	12	141
●	Y099125.IND16PIN	125	119	32	25	20	24	59,5	16	278
●	Y099160.IND20PIN	160	152	40	31	25	30	75,5	20	564