



1-099SL Quarter-Turn PrA SNAP-LINE



PA Quarter-turn for snap-in installation into cutout A

Benefits:

- ▶ RH / LH application by rotatable bottom part.
- ▶ By using additional extensions this Quarter-turn can also be applied for cutouts B and C.
- ▶ The Quarter-turn can be snapped-in as a completely pre-assembled unit.
- ▶ Also a 3-point cam can be pre-assembled.
- ▶ IP65 according to DIN EN 60529 by using the sealing kit (in combination with extensions IP54).

Material:

- ▶ **Housing:** PA, black
- ▶ **Bottom:** zinc die, zinc plated
- ▶ **Grounding clip:** stainless steel
- ▶ **O-ring:** NBR, black

- 1. = Rotatable bottom
- 2. = Sealing kit IP65
- d) = Grounding clip
- g) = Sealing kit for escutcheon

H-dimension of the cam ≥ 16 mm (5/8").



Housing with rotatable bottom and O-ring

	Part Number	Housing length	Grounding type	Installation type	Clamping range	Packaging unit
a)	408-9305.00-00010	L18	Grounding clip	tool-less	0.8 – 1.3	50 Pcs.
a)	408-9305.00-00015	L18	Grounding clip	tool-less	1.3 – 1.8	50 Pcs.
a)	408-9305.00-00020	L18	Grounding clip	tool-less	1.8 – 2.3	50 Pcs.

b)

c)

d)

e)

f)

g)

Complementary Products:

1-101	Inserts Pr20.1
1-102	Cams L35/45
3-136SL	Cutout-Cover PrA, PrB and PrC SNAP-LINE
200-1104.93-00000	Grounding clip
208-0523.03-00000	Extension, long
208-0522.03-00000	Extension, long
209-9002.00-00000	Sealing kit IP65
200-0002.00-00000	Assembling cam with o-ring
200-0020.00-00000	Assembling cam, LH door
200-0021.00-00000	Assembling cam, RH door

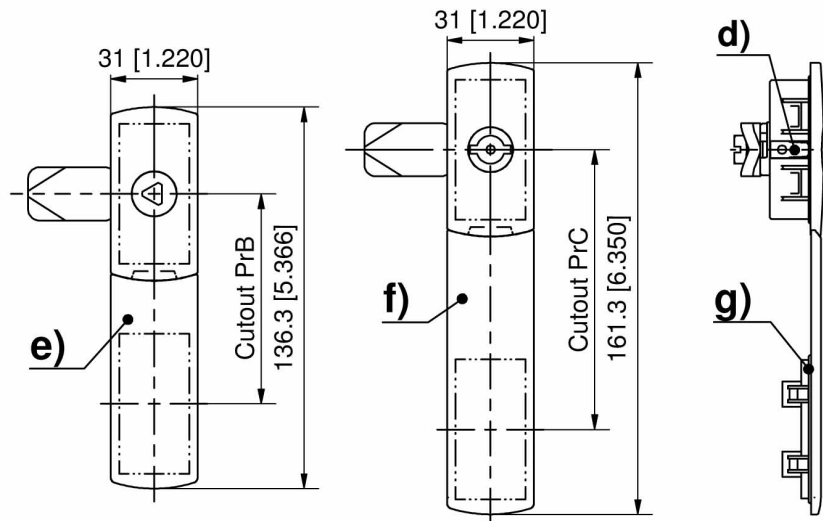

Cutout incl. paint

