



## 6-1411SL Dish Handle SNAP-LINE



Polyamide, clip-in

### Benefits:

- ▶ Dish handle SNAP-LINE, clip-in for door-thickness 0.75 to 2.2mm (0.030 to 0.087).
- ▶ Outside dimensions 94 x 41mm (3.701 x 1.614).
- ▶ The dimensions of the cutouts for different door-thicknesses are indicated in the drawing.

### Material:

- ▶ **Dish handle:** PA, black



## Dish handle

Part Number	Installation type
213-0703.03-00000	clip-in

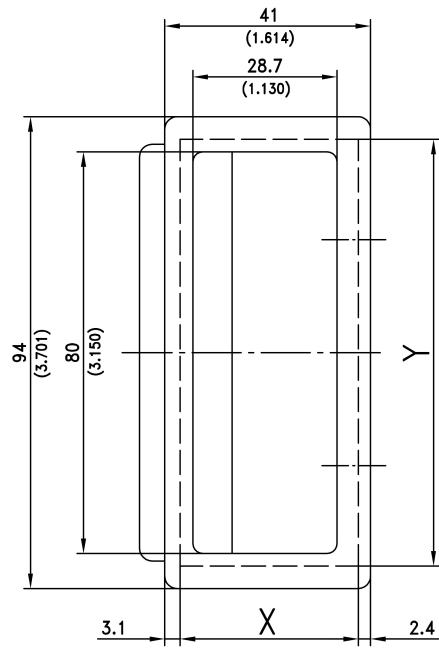
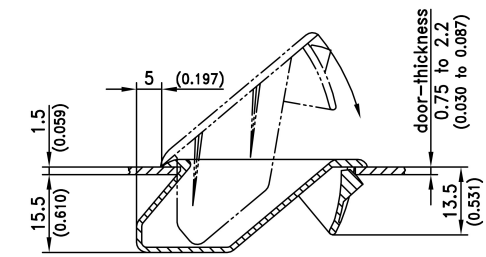

Door-thickness in mm/inch	Dimensions of cutout in mm/inch	
	X	Y
0.75-0.79 / 0.030-0.031	34.8+0.2 / 1.370	85.0+0.2 / 3.346
0.8-1.4 / 0.032-0.055	35.0+0.2 / 1.378	85.0+0.2 / 3.346
1.5-2.2 / 0.059-0.087	36.0+0.2 / 1.417	85.0+0.2 / 3.346