



## 7-100 Quarter-Turn with L-Handle Pr20.1 L18

for cutout 20.1, length 18, for padlock, stainless steel AISI 316

### Benefits:

- Quarter-Turn with L-handle for padlock.
- RH or LH application.
- Water- and dust-tight according to IP65 DIN EN 60529.
- The Quarter-Turn consists of two basic components which can be combined to suit your application.
- On request parts can be assembled by DIRAK.
- A pre-assembled Quarter-Turn can be installed in the cutout.
- **Padlock feature only if cam is at 90° to the L-handle.**

### Material:

- **L-Handle:** completely stainless steel AISI 316, surface polished
- **Grounding nut and cam:** stainless steel

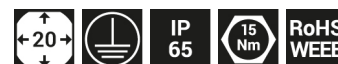

## Quarter-turn with L-handle

	Part Number	Latching type	Housing length	Door-thickness	Material	Surface	Grounding type	Installation type
a)	200-9481.00-00000	Padlock	L18	max.8mm	stainless steel	stainless steel	Grounding nut	screw-on

### Complementary Products:

	7-105	Cams L35/45
b)	1-102	Cams L35/45
b)	1-262	Cam with or without ramp
b)	200-0019.00-00000	Assembling cam 90° to handle without o-ring
c)	200-0020.00-00000	Assembling cam, LH door
c)		

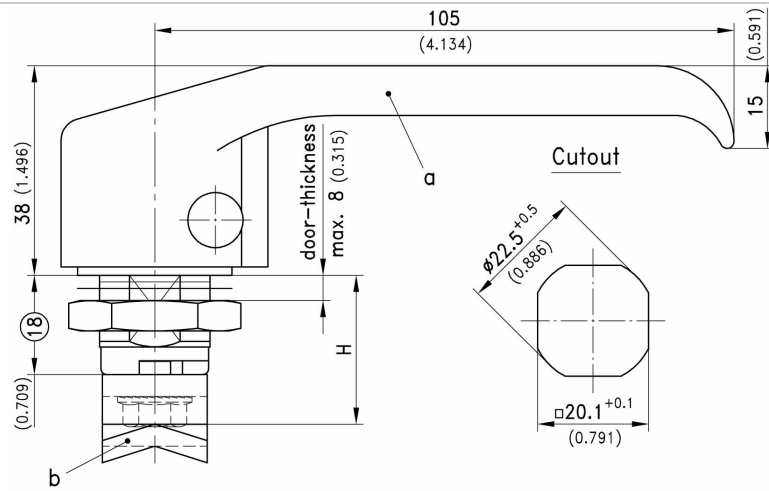

Installed position of the housing, seen from outside of the door, at

