



### 3-400E Swinghandle base with LED Module



LED module visualises the locking position and regular red flashing indicates open position

#### Advantages

- Tool-less assembly.
- Tool-less pre-installation, self-locking (clip-in) in sheet metal with thickness of 1.5 or 2.0mm.
- Independent of panel thickness up to 3mm.
- Closing with slam latch.
- Handle with lifting spring.
- Tool-less replacement of the cylinder cover.
- RH / LH application.
- IP65 according to DIN EN 60529 by optional sealing kit 307-9153.00-00000.
- For profile-cylinder with closing position 6 o'clock.

#### Materials

- **Handle, dish, cap:** PA, black
- **Cylinder dustcover:** PA, black
- **Shaft:** Grivory
- **Slam lock:** POM
- **LED carrier plate:** PMMA
- **Spring:** steel
- **O-ring:** NBR

#### Remarks

1. = Flashing LED module.  
Battery CR2032 3V **not** included



### Swinghandle PA, black, for profile-cylinder with LED module

	Part Number	Latching type	Material cylinder cover	Installation type
a)	307-9105.00-00000	profile-cylinder 40mm	PA, black	tool-less

### Swinghandle PA, black, slam latch with LED module

	Part Number	Latching type	Material cylinder cover	Installation type
a)	307-9106.00-00000	self-locking	PA, black	tool-less

#### \* Specific accessories

3-400 **Accessories for Swinghandle base**

3-440 **Bearing Plate RS base**

307-9154.00-00000 **Rod latch adapter**

#### **Complementary products**

c) 3-130 **Rod Latch FS PrC**

211-9004.00-00000 **DIRAK Profile-cylinder**

211-9003.00-00000 **DIRAK Profile-cylinder**

#### **Function extension**

b) 307-9153.00-00000 **Sealing kit + Cap**

Program  
Cutout  
Version A  
(PrA)

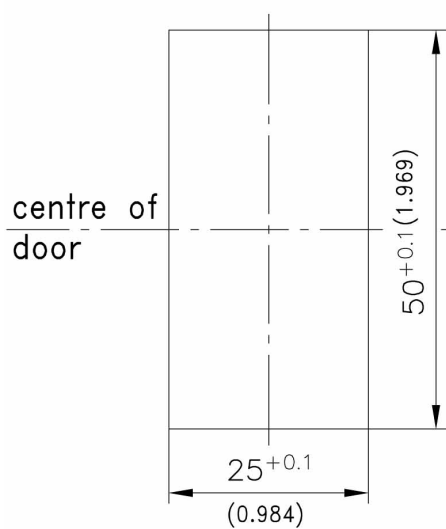

Program  
Cutout  
Version B  
(PrB)

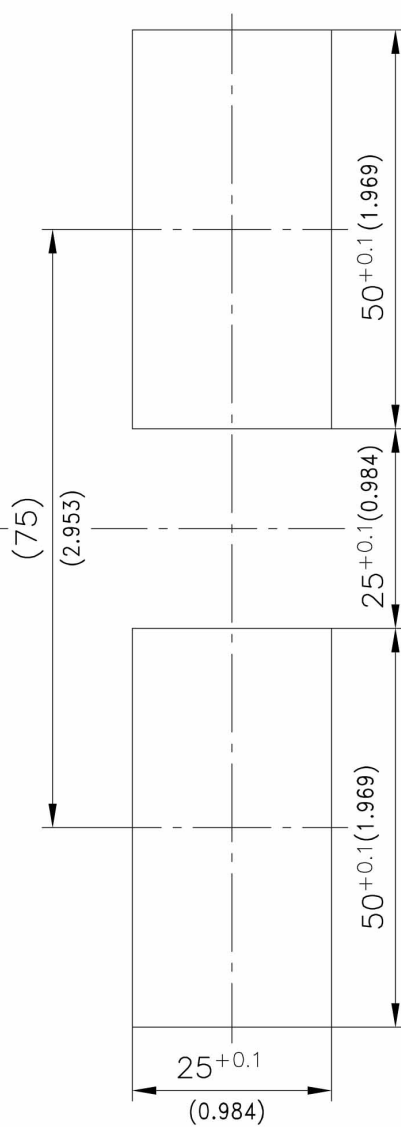

Program  
Cutout  
Version C  
(PrC)

