

## MF series

### Caratteristiche

#### Materiale Corpo:

Mescola Gomma NR/SBR

#### Durezza standard:

60 Shore A

#### Tolleranza sulla durezza:

+/- 5 SH

#### A richiesta:

Differenti lunghezze della Vite,  
Inserto Femmina Passante

#### Parte Metallica e/o

#### Fissaggio:

Rondella Sabbziata e Zincata

#### Tipo Inserto Standard:

Vite Zincata, Inserto Femmina Cieco

#### Product specification

#### Main Part Material:

NR/SBR Rubber Compound

#### Standard Hardness:

60 Shore A

#### Hardness Tolerance:

+/- 5 SH

#### On request:

Different Screw Lengths,  
Threaded Thru-Hole

#### Metallic Part Material &

#### Finishing:

Zinc Plated Washers

#### Standard Thread:

Zinc Plated Screw, Threaded  
Blind Hole

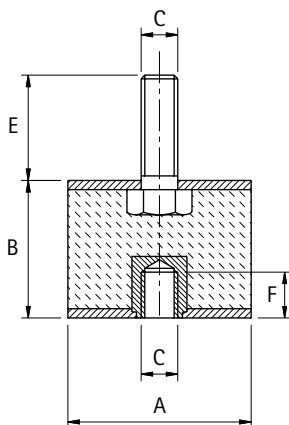

## Maschio/Femmina Type B (Male/Female)

Codice	A	B	C	E	F	Carico max a Compres. daN Max Compression Load daN	Carico max a Taglio daN Max Shear Load daN	Confezione Pz Packing Pcs.
A1MF1515	15	15	M4	14	4	15	3	1
A1MF2015	20	15	M6	16	6	34	3	1
A1MF2020	20	20	M6	16	6	29	2	1
A1MF2025	20	25	M6	16	6	19	2	1
A1MF2030	20	30	M6	16	6	15	2	1
A1MF2515S	25	15	M6	8	6	40	6	1
A1MF2515	25	15	M6	18	6	40	6	1
A1MF2520/6	25	20	M6	18	8	45	5	1
A1MF2520/8	25	20	M8	20	8	45	5	1
A1MF2525	25	25	M6	18	8	40	4	1
A1MF2530	25	30	M6	18	8	35	3	1
A1MF3015	30	15	M8	18	8	58	10	1
A1MF3020	30	20	M8	23	6	66	9	1
A1MF3020-14	30	20	M8	14	6	66	9	1
A1MF3030	30	30	M8	23	10	61	7	1
A1MF3040	30	40	M8	23	10	54	5	1
A1MF4020	40	20	M8	23	6	88	16	1
A1MF4030/10	40	30	M10	28	10	98	15	1
A1MF4030/8	40	30	M8	23	10	98	15	1
A1MF4035	40	35	M8	23	10	88	13	1
A1MF4040/10	40	40	M10	28	10	108	13	1
A1MF4040/8	40	40	M8	23	10	108	13	1
A1MF5020	50	20	M10	28	10	169	21	1
A1MF5030	50	30	M10	28	10	159	20	1
A1MF5040	50	40	M10	28	10	144	18	1
A1MF5050	50	50	M10	28	10	134	14	1
A1MF6030/12	60	30	M12	37	11	228	40	1
A1MF6035/10	60	35	M10	28	10	228	40	1
A1MF6040/12	60	40	M12	28	11	214	30	1
A1MF6050/10	60	50	M10	35	10	200	24	1
A1MF6050/12	60	50	M12	37	11	200	24	1
A1MF6535	65	35	M12	37	11	300	46	1
A1MF6550	65	50	M12	37	11	230	23	1
A1MF7050/12	70	50	M12	37	11	280	38	1
A1MF7525	75	25	M12	37	11	382	89	1
A1MF7540	75	40	M12	37	11	378	78	1
A1MF7550	75	50	M12	37	11	373	68	1
A1MF10030	100	30	M16	45	16	720	110	1
A1MF10040	100	40	M16	45	16	686	98	1
A1MF10050	100	50	M16	45	16	660	98	1
A1MF10055	100	55	M16	45	16	636	78	1
A1MF10060	100	60	M16	45	16	586	48	1

# A1 Zinc plated cylindrical mountings

## Maschio/Femmina a Gomma Tenera Soft type B (Male/Female)

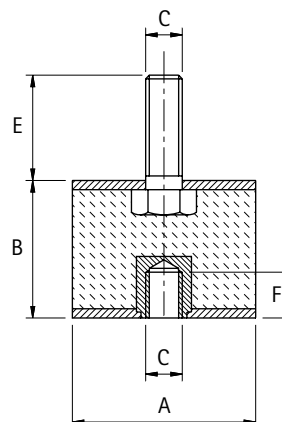

## MFT series

### Caratteristiche

#### Materiale Corpo:

Miscela Gomma NR/SBR

#### Durezza standard:

45 Shore A

#### Tolleranza sulla durezza:

+/- 5 SH

#### A richiesta:

Differenti lunghezze della Vite,  
Inserto Femmina Passante

#### Parte Metallica e/o

#### Fissaggio:

Rondella Sabbiata e Zincata

#### Tipo Inserto Standard:

Vite Zincata,  
Inserto Femmina Cieco

#### Product specification

#### Main Part Material:

R/SBR Rubber Compound

#### Standard Hardness:

45 Shore A

#### Hardness Tolerance:

+/- 5 SH

#### On request:

Different Screw Lengths,  
Threaded Thru-Hole

#### Metallic Part Material &

#### Finishing:

Zinc Plated Washers

#### Standard Thread:

Zinc Plated Screw, Threaded  
Blind Hole

Codice	A	B	C	E	F	Carico max a Compres. daN Max Compression Load daN	Carico max a Taglio daN Max Shear Load daN	Confezione Pz Packing Pcs.
A1MFT2025	20	25	M6	16	6	11	1,3	1
A1MFT2520	25	20	M6	18	8	27	3,3	1
A1MFT3030	30	30	M8	23	10	37	4,7	1
A1MFT4030	40	30	M8	23	10	59	10	1
A1MFT5030	50	30	M10	28	10	95	13	1
A1MFT5035	50	35	M10	28	10	95	13	1
A1MFT5050	50	50	M10	28	10	80	9,4	1
A1MFT6035	60	35	M10	30	10	137	27	1
A1MFT7550	75	50	M12	37	11	224	45	1