

DUAL SWITCH WELDING MAGNET

The main uses and characteristics

Application : Suitable to welding fix the inside square corner of various magnetic material.

- Features :
1. Two ON/OFF switches for independent operation.
 2. Hold flat and round metal workpieces.
 3. Easy and safe set-up.

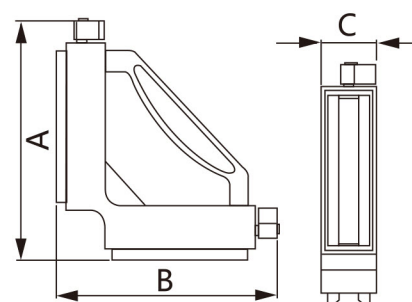

The above products specifications and dimensions are for reference only, shall be subject to the actual product by our company, are subject to change without prior notice

SQUARE WELDING MAGNET

The main uses and characteristics

Application : Suitable to welding fix the inside square corner of various magnetic material.

- Features :
1. A switch controls the magnetic force of the welding magnet.
 2. Fast and safe set-up.
 3. Easy to clean. Simply turn off and wipe.

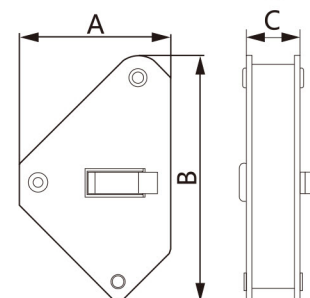

The above products specifications and dimensions are for reference only, shall be subject to the actual product by our company, are subject to change without prior notice