

# MWC3 MAGNETIC CLAMP



## The main uses and characteristics

**Application :** This magnetic clamps are ideal for downward pressure clamping and come with screw holds for fast mount. Simple drill a hole in the fixturing material and place the clamp in. We recommend at least two clamps per fixture to minimize slippage.

**Features :** This magnetic clamp is suitable to fix iron plate, tube, stick, wood, angle steel and channel steel etc, to prevent them from moving. The bottom of the clamp and both 4sides have magnetics, creat precise 90°degrees. Controlled by a 180°On/Off switch, simple operate and fast set up anywhere on ferrous metal.

Model	(mm) Shape Size					(mm) Full Saturation Thickness	1/2(kg) Shear Working Load	(kg) Pull Off Force	(kg) Weight
	A	W	W1	H	B				
MWC3S	48	31.5	74.5	66	63	5	6	60	0.4
MWC3M	65	41.5	88	80	75	5	8	120	0.685
MWC3L	69	41.5	88	80	75	5	10	185	0.88

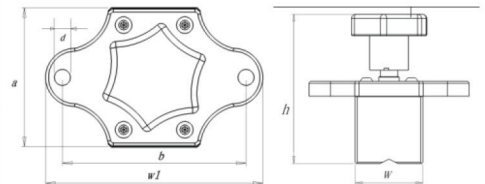

The above products specifications and dimensions are for reference only, shall be subject to the actual product by our company, are subject to change without prior notice

# MWC2 SQUARE MAGNETIC CLAMP

## The main uses and characteristics

**Application :** This square magnetic clamp is suitable to fix iron plate, tube, stick, wood, angle steel and channel steel etc, to prevent them from moving.

**Features :**

1. The bottom of the clamp and both four sides have magnetics, six sides machined at the angle of 90°
2. Controlled by a 180°On/Off switch, simple operate and fast set up anywhere on ferrous metal.

Model	A	(mm) Shape Size		(mm) Full Saturation Thickness	1/2(kg) Shear Working Load	(kg) Pull Off Force	(kg) Weight
		W	H				
MWC2S	48	31.5	66	4	6	60	0.38
MWC2M	60	41.5	80	5	8	120	0.65
MWC2L	64	49	90	7	10	185	1.07

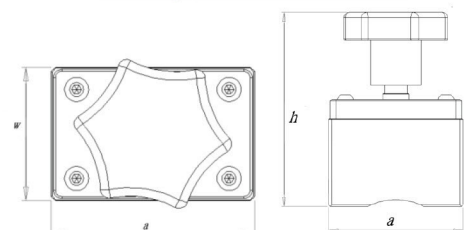

The above products specifications and dimensions are for reference only, shall be subject to the actual product by our company, are subject to change without prior notice