

B240

NEW



PA6
+G.F.

UL94
HB

RoHS
COMPLIANT

SOLID HANDLE WITH SCREW AND NUT

Materials:

Reinforced polyamide.
Resistant to oils and greases.

Surface finish:

Satin.

Colour:

Black: (RAL 9011 cod. 01).

Inserts:

B240:

2 galvanised steel screws DIN 912.
2 galvanised steel nuts DIN 934.
2 galvanised steel perforated washers.

B240CIN:

2 stainless steel screws (Aisi 304) DIN 912.
2 stainless steel nuts (Aisi 304) DIN 934.
2 stainless steel perforated washers (Aisi 304).

Special requests:

- None.

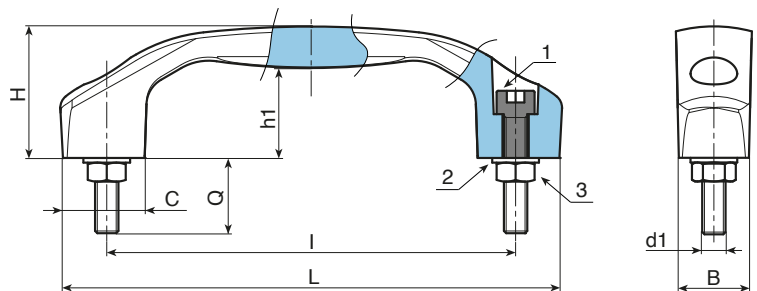

Version B240: with galvanised steel inserts

art.	L	I	B	C	H	h1	d1 _{6g}	Q	g	F1 (N)
B240100.TM05X2001	122	100	17	20	33	23,5	M5	20	53	1000
B240120.TM06X2501	146	120	21	24	39	27,5	M6	25	93	1000
B240140.TM08X3001	170	140	24	28	45	31	M8	30	150	1000

Version B240CIN: with stainless steel inserts (Aisi 304)

art.	L	I	B	C	H	h1	d1 _{6g}	Q	g	F1 (N)
B240100.TM05X2001CIN	122	100	17	20	33	23,5	M5	20	53	1000
B240120.TM06X2501CIN	146	120	21	24	39	27,5	M6	25	93	1000
B240140.TM08X3001CIN	170	140	24	28	45	31	M8	30	150	1000

INOX



Stock availability as % (🛒)
90% (●) - 40% (●) - 5% (●)