

H171 CON



PA6
+GF

UL94
HB



KNURLED HANDWHEEL WITH SHORT HUB AND THREADED FEMALE INSERT

Material: Reinforced polyamide. Oils and greases resistant.

Surface: Satin.

Colour: Black (RAL 9011).

Main Insert: Brass blind threaded bush (tolerance 6H).

SPECIAL REQUEST:

- None.

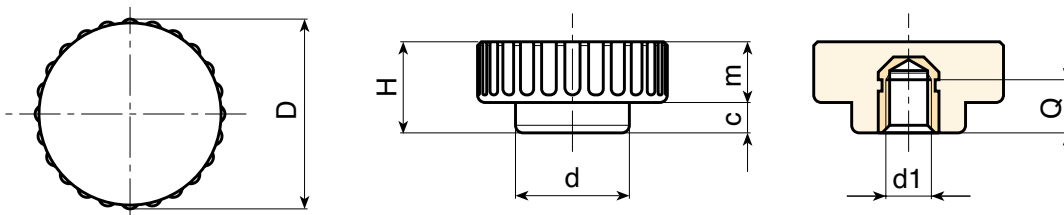

art.	D	H	d	m	c	d1 6H	Q	g
H17125.TM0601CON	25	12	15,5	4	8	M06	7	7
H17125.TM0801CON	25	12	15,5	4	8	M06	7	8

H171



PA6
+GF

UL94
HB



KNURLED HANDWHEEL WITH SHORT HUB AND THREADED STUD

Material:

Reinforced polyamide. Oils and greases resistant.

Surface: Satin.

Colour: Black (RAL 9011).

Main Insert: Zinc plated steel threaded stud (tolerance 6g).

SPECIAL REQUESTS:

- It is possible to supply inserts in different lengths or by special design, on request and for quantities.

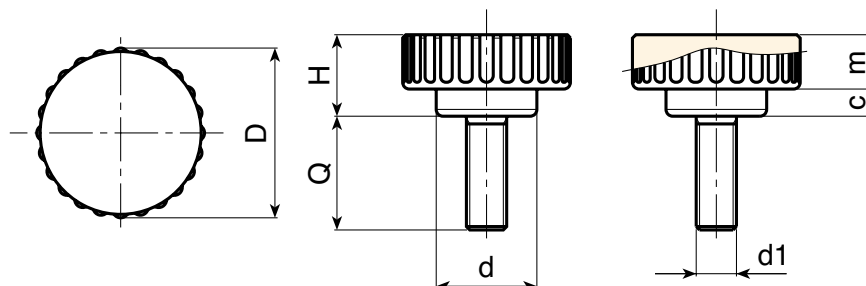

art.	D	H	d	m	c	LM	d1 6g	Q	g
H17125.TM06X..01	25	12	15,5	4	8	40	M06	A.R.	
H17125.TM08X..01	25	12	15,5	4	8	40	M06	A.R.	

Enter the stud length choice in the two .. of the article code. Lengths by request with 250 pieces minimum quantity.

LM = Maximum mouldable length.

A.R. = by request.

**H - KNURLED
HANDWHEELS**

ver. HUK.10-0113



BOTECA

H - 18

Presumable presence in the stock in %

(☹) 90% (😊) 40% (☺) 5% (☹)

www.boteca.it - © All right reserved - BOTECA®

Any unauthorized reproduction is strictly forbidden