

# MWC4 / MWC5

## MULTI-ANGLE MAGNETIC CLAMP

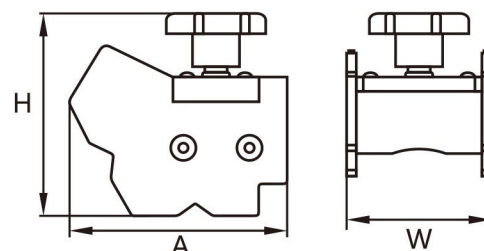
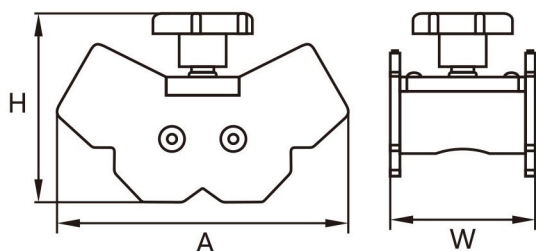

### The main uses and characteristics

Application : This multi-angle magnetic clamp is suitable to fix iron plate, tube, stick, angle steel and channel steel etc, to prevent them from moving.

- Features : 1. Multi sides have strong magnetic, can form precise multi angles 90°, 45/135°, 105/75°, 60/120°.  
2. Controlled by a 180°On/Off switch, simple operate and fast set up anywhere on ferrous metal.

Model	A	(mm) Shape Size W	H	(mm) Full Saturation Thickness	(kg) test max pull off force	Angles	(kg) Weight
MWC4S	111	55	76	4	60	45°/60°/75°/90° 105°/120°/135°	0.65
MWC4M	142	70	90	5	120		1.1
MWC5S	78	55	76	4	60	60°/90°/120°	0.56
MWC5M	112	70	90	5	120		1.04

The above products specifications and dimensions are for reference only, shall be subject to the actual product by our company, are subject to change without prior notice